

Tambai II

Landing Craft

www.polarismarine.com.au



MAIN PARTICULARS

Design	Landing Craft
Year Built	1984 Rebuilt 1999
Flag	Australia
Survey	NSCV 2C
Class	N/A
GRT	80t
Max DWT	N/A
Length	24.9m
Moulded Breadth	6.09m
Moulded Depth	2.13m
Draft	1.5m
Deck Capacity	100m2

PERFORMANCE

Max Speed	9kt
Bollard Pull	N/A
Fuel Consumption	50L p/h

CAPACITIES

Fuel	118,000 L
Portable Water	4,000 L

DECK EQUIPMENT

Towing Hook	N/A
Towing Winch	N/A
Drum Capacity	N/A
Tugger Winch	N/A
Capstan	N/A
Stern Roller	N/A

AUXILIARY

Generator	2 x 30kVa
Supply System	Battery Sets 240V / 24V

PROPULSION & MACHINERY

Main Engines	Caterpillar D333
Power Rating	2 x 196 Bhp
Gear Boxes	Twin Disc 509 3:1
Propellers	Twin Screw
Steering Gear	Powered Hydraulic Open Props with Rudders

ACCOMMODATION

Berths	4
Air-conditioning	N/A



Gate 2, James Craig Road, Rozelle, New South Wales 2039
PO Box 1771, Rozelle, New South Wales 2039
T: +61 2 9563 8333 • F: +61 2 9563 8300 • E: admin@polarismarine.com.au

The particulars are believed to be correct, but are not guaranteed. Particulars given are entirely without warranty on accuracy.

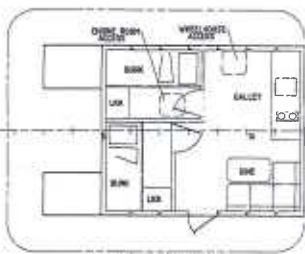
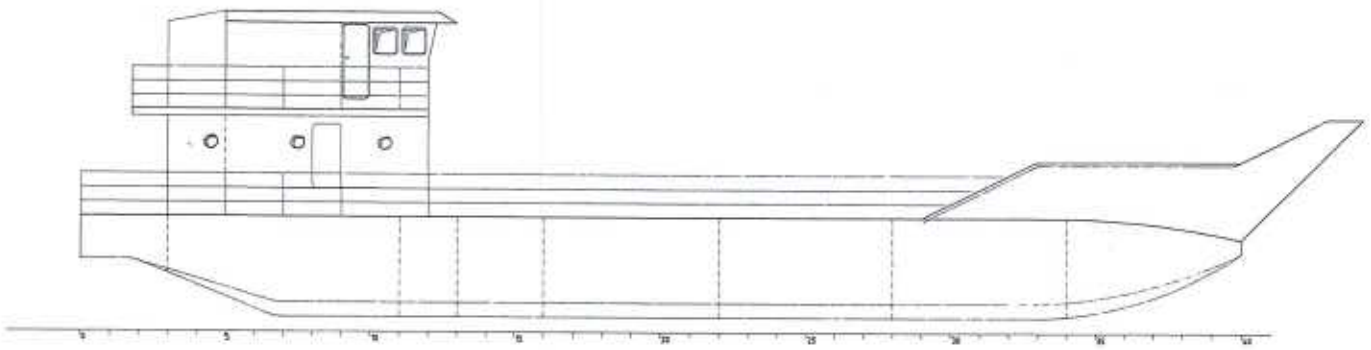

MAIN DECK PLAN

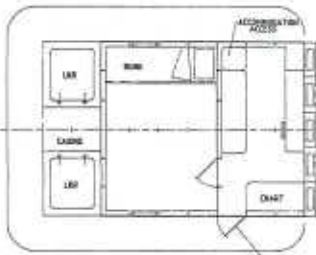

WHEELHOUSE PLAN

REV	DESCRIPTION	CHK	DATE	BY	DATE
		007 Little Venice Street P.O. Box 840 Cairns Queensland 4870 Australia Tel: (07) 4033 1458 Fax: (07) 4033 1403 Email: glanville@glanville.com.au			
CLIENT	JARDINE SHIPPING	TITLE			
PROJECT	TANBAI II	GENERAL ARRANGEMENT			
DO NOT SCALE THE DIMENSIONS AND INFORMATION CONTAINED HEREIN IS SUPPLIED IN THE UNDERSTANDING THAT IT IS THE SOLE PROPERTY OF GLANVILLE & COMPANY ARCHITECTS PTY. LTD. AND MUST NOT BE REPRODUCED IN WHOLE OR IN PART WITHOUT PERMISSION IN WRITING.		DRAWN BY D. LAHONT	DATE 4/6/99	SCALE 1:50	SHEET NO. 1049/01
CHECKED BY C.M.S.	DATE 27/7/99	DESIGNED BY C.M.S.		DATE 27/7/99	SHEET 1 OF 1

NOTED
 REVISIONS
 DATE: 08/07/99
 BY: V.K.C.